

H2020 Series 7.0mm 2.0ø Crimp Terminal Housing

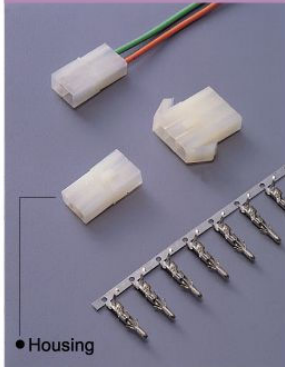

H
2020
—
12
P
T
N
W
0
0

- | | | |
|---|---|--|
| <p>1. PRODUCTS:
H:Housing</p> <p>2. SERIES NO.:
2020(Female Housing)</p> <p>3. CONTACT NO.:
02-04
04(2x2),06(2x3)
09(3x3),12(3x4)
15(3x5)</p> | <p>4. CONTACT TYPE:
P:Non Distribution</p> <p>5. ROW TYPE:
S:Single Row
D: Dual Row
T: Three Row</p> <p>6. BODY OPTION:
N:Without Ear
B:Bevel Ear</p> | <p>7. INSULATOR COLOR:
W:White</p> <p>8. FILL IT WITH"0"</p> <p>9. FILL IT WITH"0"</p> |
|---|---|--|

1 H2020-XXPXBW00R 2.0mm FEMALE HOUSING

SPECIFICATION

- ◆ Current rating: 15A AC, DC max.
- ◆ Voltage rating: 300V AC, DC
- ◆ Temperature range: -25 °C ~ +90 °C
(including temperature rise)
- ◆ Contact resistance: Initial value:7m Ω max.
After environmental testing/10m Ω max.
- ◆ Integrally molded polarization
- ◆ Nylon 66, 94V-2
- ◆ Standard color: white
- ◆ Insulation resistance: 1,000M Ω min.
- ◆ Withstand voltage: 1500V AC/minute
- ◆ Applicable wire: AWG#24-14
0.2-2.0mm
- ◆ Applicable panel thickness: 0.831" ~ 0.79"
(0.8-2.0mm)
- ◆ 1,2,3,4,6,9,12,15 circuit versions
- ◆ Positive locking

CIRCUIT	PLUG	CIRCUIT	PLUG	CIRCUIT	PLUG
1		4		9	
2		4		12	
3		6		15	

ELECTRONIC COMPONENTS

2

T2020-TBA00000R**φ2.0mm MALE TERMINAL BRASS MATERIAL AWG 14~18**

6.2mm (.244") Pitch Wire-to-Wire L Connector/Terminal

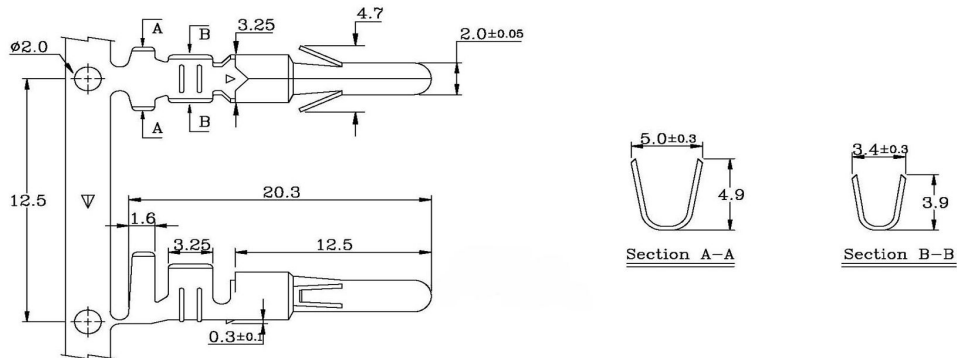

Specifications & Ordering Information

Thickness	Material	Wire Range	Insulation O.D.	Finish	Qty/reel
0.25	Brass	AWG #14-18	3.5-2.8 mm	Pre. Tin-Plated	4,000

3

T2020-TBD00000R**φ2.0mm MALE TERMINAL BRASS MATERIAL AWG 18~22**

6.2mm (.244") Pitch Wire-to-Wire L Connector/Terminal

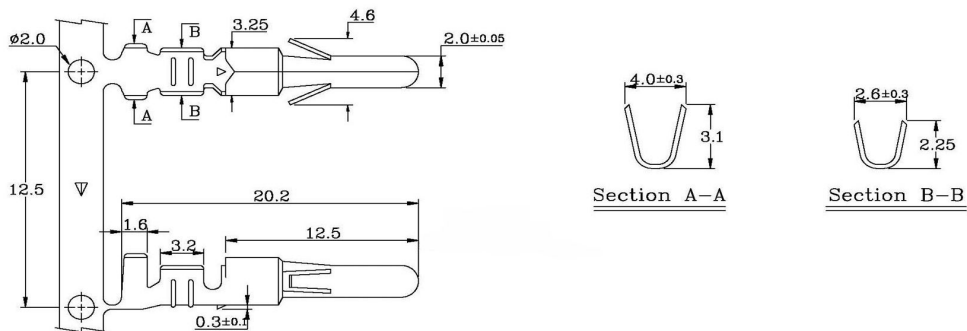

Specifications & Ordering Information

Thickness	Material	Wire Range	Insulation O.D.	Finish	Qty/reel
0.25	Brass	AWG #18-22	2.8-2.4 mm	Pre. Tin-Plated	5,000

ELECTRONIC
COMPONENTS