

C0112 Series SIP Socket Machined Pin

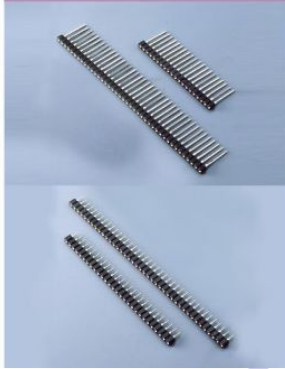

C	0112	—	10	S	A	A	B	0	0
1	2		3	4	5	6	7	8	9

- | | | | |
|--|--|---|---|
| <p>1. PRODUCTS:
C: Connector</p> <p>2. SERIES NO.:
0112</p> <p>3. CONTACT NO.:
01-40(1x1-1x40)
02-80(2x1-2x40)</p> <p>4. ROW TYPE:
S: Single Row
D: Dual Row</p> | <p>5. FINGERED CLIP OPTION:
A: Four Fingered Clip</p> <p>6. CONTACT PLATING:
A: Length 7.4mm
Tin Plated
B: Length 7.4mm
Gold Plated
C: Wire Wrap 17.75mm
Tin Plated
D: Wire Wrap 17.75mm
Gold Plated</p> | <p>E: Length 13.4mm
Tin Plated
F: Length 13.4mm
Gold Plated</p> <p>7. INSULATOR COLOR:
B: Black</p> | <p>8. FILL IT WITH "0"</p> <p>9. FILL IT WITH "0"</p> |
|--|--|---|---|

1

C0112-XXDAA(B)B00R

2.54mm SIP SOCKET MACHINED PIN DUAL ROW

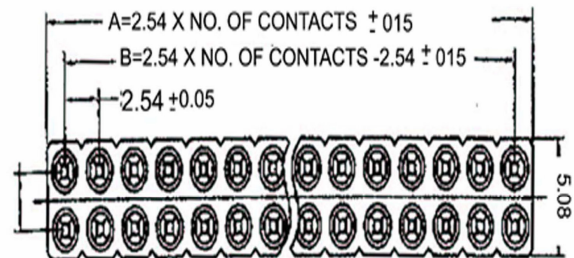
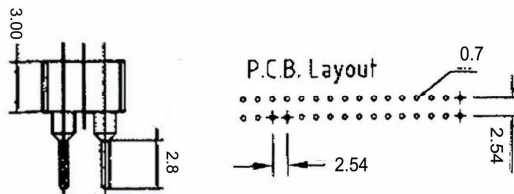

Technical Data

Material:

Pin(outer sleeve): Brass, machined CuZn38Pb2

Plating(outer sleeve):

Tin plated: 2um/80u" Ni, 5um/200u" Sn

Gold Plated: 2um/80u" Ni, Full gold

Insulator(black): Glass filled thermoplastic polyester
UL94V-0

Electrical:

Current rating: 3Amps/contact max.

Contact resistance: $\leq 4m\Omega$ /contactInsulation resistance: $\geq 1000M\Omega$ at V=100V

Operating voltage: 60VAC/DC

Mechanical:

Operating temperatures: Gold Plated: -55°C to +125°C

Tin plated: -40°C to +105°C

Soldering temperature: +260°C, 10s max.

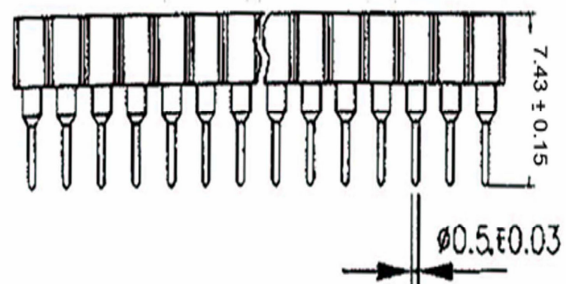
ELECTRONIC
COMPONENTS

2

C0112-XXSAAB00R
2.54mm SIP SOCKET MACHINED PIN 4 PINGERED CLIP 1XXP

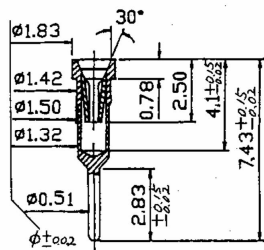
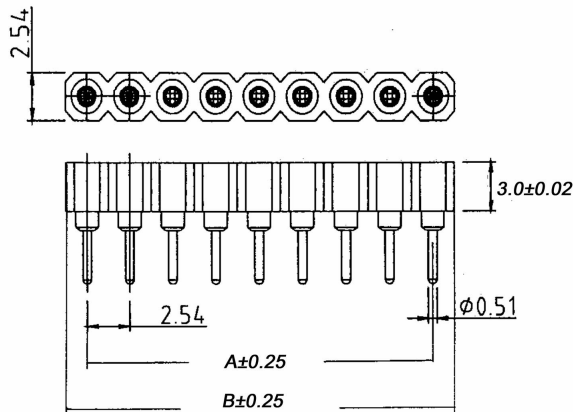

MATERIAL:
 INSULATOR:PPS
 COLOR:BLACK
 SLEEVE:BRASS
 PLATING:TIN PLATED/GOLD

No of contacts	Dim A	Dim B	No of contacts	Dim A	Dim B
1		2.54	21	50.80	53.34
2	2.54	5.08	22	53.34	55.88
3	5.08	7.62	23	55.88	58.42
4	7.62	10.16	24	58.42	60.96
5	10.16	12.70	25	60.96	63.50
6	12.70	15.24	26	63.50	66.04
7	15.24	17.78	27	66.04	68.58
8	17.78	20.32	28	68.58	71.12
9	20.32	22.86	29	71.12	73.66
10	22.86	25.40	30	73.66	76.20
11	25.40	27.94	31	76.20	78.74
12	27.94	30.48	32	78.74	81.28
13	30.48	33.02	33	81.28	83.82
14	33.02	35.56	34	83.82	86.36
15	35.56	38.10	35	86.36	88.90
16	38.10	40.64	36	88.90	91.44
17	40.64	43.18	37	91.44	93.98
18	43.18	45.72	38	93.98	96.52
19	45.72	48.26	39	96.52	99.06
20	48.26	50.80	40	99.06	101.6

3

C0112-XXSAEB00R
2.54mm SIP SOCKET MACHINED PIN 4 FINGERED CLIP XXP

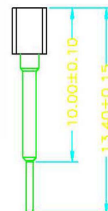
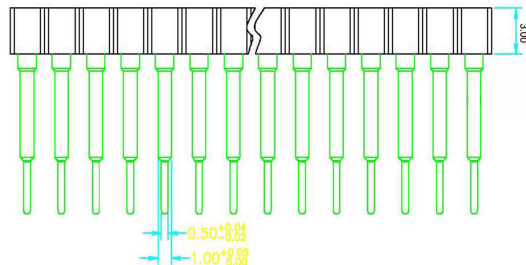

Technical Data

Material:
 Pin(outer sleeve): Brass,machined CuZn38Pb2
 Clip(contact 4 finger): phosphor bronze,heat treated
 Plating(outer sleeve):
 Tin plated:2µm/80µ"Ni, 5µm/200µ"Sn
 Gold Plated:2µm/80µ"Ni,0.8 µ " gold
 Plating(contact): 2µm/80µ"Ni, gold or Tin plated
 Insulator(black): Glass filled thermoplastic polyester
 UL94V-0

Electrical:
 Current rating: 3Amps/contact max.
 Contact resistance: ≤4mΩ/contact
 Insulation resistance: ≥1000MΩ at V=100V
 Operating voltage: 60VAC/DC

Mechanical:
 Average insertion force with steel pin of
 Ø0.43mm/0.17": <250g
 Average withdrawal force with steel pin of
 Ø0.43mm/0.17": >25g min.
 Mechanical life cycle:min.200
 Operating temperatures: Gold Plated:-55°C to+105°C
 Tin plated:-40°C to+105°C
 Soldering temperature: +260°C,10s max