

H2011 Series 2.0mm Crimp Terminal Housing



H **2011** — **02** **P** **W** **0** **0** **0** **0**

1 2 3 4 5 6 7 8 9

1. PRODUCTS:
H:Housing

2. SERIES NO.:
2011

3. CONTACT NO.:
02-15

4. CONTACT TYPE:
P:Non Distribution

5. INSULATOR COLOR:
W:White

6. FILL IT WITH "0"

7. FILL IT WITH "0"

8. FILL IT WITH "0"

9. FILL IT WITH "0"

H2011-XXPW0000R

材質(Material): 尼龍[PA66 UL 94V Grade]

顏色(Color): 白色(White)

配合端子(Mates with terminal):
T2011-TP900000R

配合塑膠(Mates with housing):
W2111-XXPSTW00R
W2111-XXPRTW00R

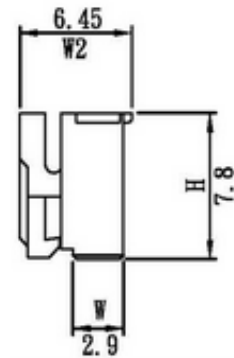
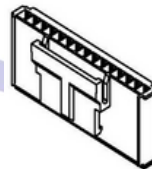

CONTACT NO.	Dimension		Q' ty/bag
	L1	L	
2P	2.0	5.6	1000 PCS
3P	4.0	7.6	1000 PCS
4P	6.0	9.6	1000 PCS
5P	8.0	11.6	1000 PCS
6P	10.0	13.6	1000 PCS
7P	12.0	15.6	1000 PCS
8P	14.0	17.6	1000 PCS
9P	16.0	19.6	1000 PCS
10P	18.0	21.6	1000 PCS
11P	20.0	23.6	500 PCS
12P	22.0	25.6	500 PCS
13P	24.0	27.6	500 PCS
14P	26.0	29.6	500 PCS
15P	28.0	31.6	500 PCS

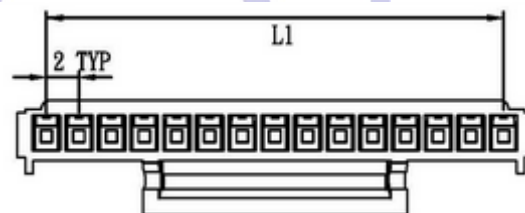
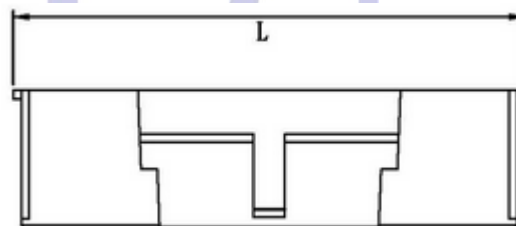

ELECTRONIC
COMPONENTS

T2011 Series 2.0mm Crimp Contacts



T	2011	—	T	P	9	0	0	0	0	0
1	2		3	4	5	6	7	8	9	10

- | | | |
|---|--|--|
| <p>1. PRODUCTS:
T:Terminal</p> <p>2. SERIES NO.:
2011</p> <p>3. CONTACT PLATING:
T: Tin
S: Selective Gold
G: Gold Flash</p> | <p>4. MATERIAL:
P: Phosphor Bronze</p> <p>5. WIRE OPTION:
9: Suitable For 24-30 Awg</p> <p>6. FILL IT WITH "0"</p> | <p>7. FILL IT WITH "0"</p> <p>8. FILL IT WITH "0"</p> <p>9. FILL IT WITH "0"</p> <p>10. FILL IT WITH "0"</p> |
|---|--|--|

T2011-TP900000R

NOTES:

- MATERIAL: PHOSPHOR BRONZE, $t=0.20\text{mm}$.
- USE WITH: TU2008 SERIES HOUSING
- FINISH: A TIN-PLATED OVER NICKEL.
AE PRESSING BEFORE TIN-PLATED OVER NICKEL.
GO GOLD FLASH OVER NICKEL.
G* GOLD *U* OVER NICKEL.
- APPLICABLE WIRE RANGE: AWG#22-#28
- INSULATION O.D.: $\phi 1.50\text{mm}$ (MAX.)
- PACKING: 10K/REEL

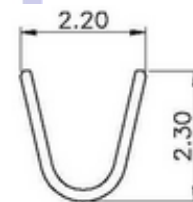
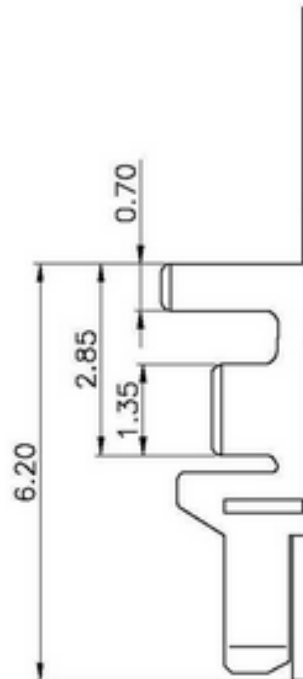
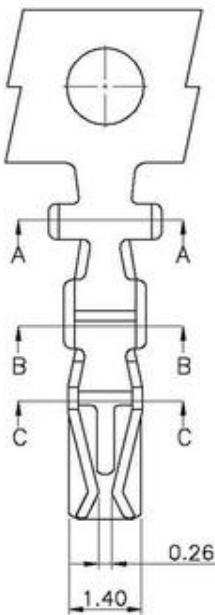

Section A-A

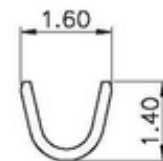

Section B-B

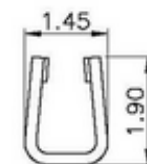

Section C-C

ELECTRONIC
COMPONENTS