

C0550 Series D-SUB P.C.B. Right Angle 7.2mm (Stamped Pin)



C **0550** — **09** **M** **A** **C** **B** **S** **B**

1 2 3 4 5 6 7 8 9

- | | | | |
|--|---|--|---|
| <p>1. PRODUCTS:
C: Connector
2. SERIES NO.:
0550
3. CONTACT NO.:
09, 15, 25, 37
4. CONTACT TYPE:
M: Male
F: Female
A: Male (E.M.I.)
B: Female (E.M.I.)</p> | <p>5. MOUNTING OPTION:
A: Boardlock (Z-Shape)
B: Rivet W/Boardlock (Z-Shape)
C: Rivet Only
D: Non Thread L-Shape
E: Rivet W/Non Thread L-Shape
F: 4-40 Thread L-Shape
G: Rivet W/4-40 Thread L-Shape
J: Rivet W/M3 Thread L-Shape</p> | <p>T: 4-Prong Boardlock
U: Rivet W/4-Prong Boardlock
6. ACCESSORIES:
A: Non Accessories
B: ADD Screws (4.8*11.8)
C: Fix Screws (4.8*11.8)
D: ADD Screws (5.8*12.0)
E: Fix Screws (5.8*12.0)
7. SHELL PLATING:
T: Tin
N: Nickel
Z: Zinc (Chromatic)</p> | <p>P: Prominent
A: Tin+Dimple
B: Nickel+Dimple
8. CONTACT PLATING:
S: Selective Gold
G: Gold Flash
A: Gold 50"
B: Gold 100"
C: Gold 150"
D: Gold 300"
9. OTHERS:
B: Black Insulator</p> |
|--|---|--|---|

1 C0550-XXAXXXXBR D-SUB 90° 7.2mm XXP MALE W/EMI

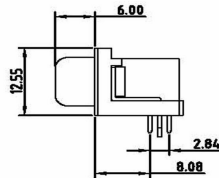
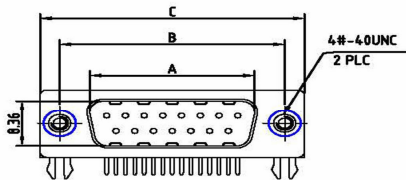

ELECTRICAL CHARACTERISTICS

Contact Current Rating: 3 Amperes.
Dielectric Withstanding Voltage: AC 500V at sea level.
Insulation Resistance: 1000 Megohms Min.
Contact Resistance: 30 Milliohms Max.
Operation Temperature: -55°C to +105°C.

Material

Contact: Copper Alloy.
Insulator: PBT. (Select PA61 /LCP /PA9T)
Shell: SPCC.
Z-Piece: Copper Alloy.
Screw: Copper Alloy.
Rivet: Copper Alloy. or Zinc.

Note:

No.	A	B	C
09	16.92	24.99	30.81
15	25.25	33.32	39.14
25	38.96	47.04	53.04
37	55.42	63.50	69.32

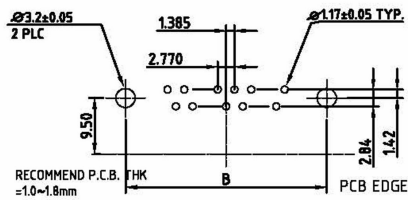
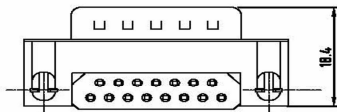

*C0550-XXAACXXBR
*C0550-XXAEXXBR

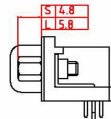

*C0550-XXABCXXBR
*C0550-XXABEXXBR

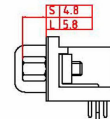

*C0550-XXABBXXBR
*C0550-XXABDXXBR

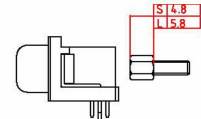

ELECTRONIC COMPONENTS

2

C0550-XXFUXXBXR
D-SUB 90° 7.2mm STAMPED PIN XXP FEMALE

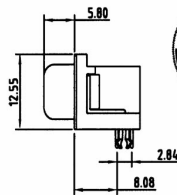
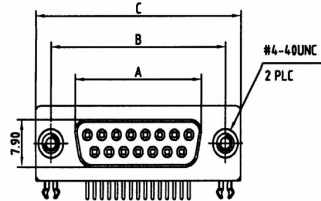

ELECTRICAL CHARACTERISTICS

Contact Current Rating: 3Amperes.
 Dielectric Withstanding Voltage: AC 500V at sea level.
 Insulation Resistance: 1000Megohms Min.
 Contact Resistance: 30Milliohms Max.
 Operation Temperature : -55°C to +105°C.

Material

Contact :Copper Alloy.
 Insulator:PBT. (Select PA6T /LCP /PA9T)
 Shell: SPCC.
 Z-Piece: Copper Alloy.
 Screw: Copper Alloy.
 Rivet: Copper Alloy. or Zinc.

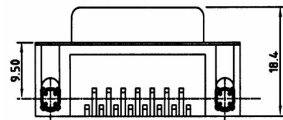

Note

No.	A	B	C
09	16.33	24.99	30.81
15	24.66	33.32	39.14
25	38.38	47.04	53.04
37	54.83	63.50	69.32

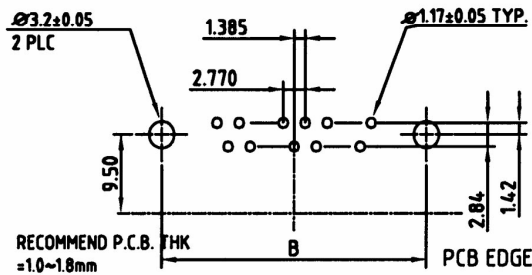

- *C0550-XXFACXXBR
- *C0550-XXFBCXXBR
- *C0550-XXFBXXBR
- *C0550-XXFAEXXBR
- *C0550-XXFBEXXBR
- *C0550-XXFBDXXBR

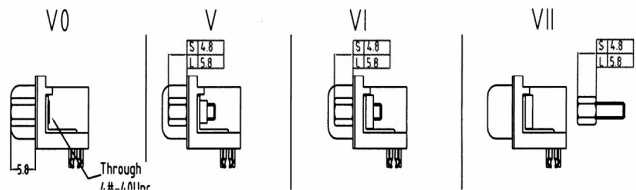

3

C0550-XXM00000R
D-SUB 90° 7.2mm XXP MALE

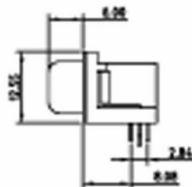
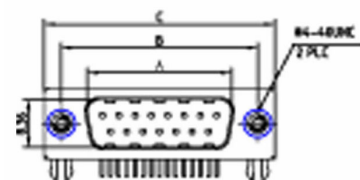

ELECTRICAL CHARACTERISTICS

Contact Current Rating: 3Amperes.
 Dielectric Withstanding Voltage: AC 500V at sea level.
 Insulation Resistance: 1000Megohms Min.
 Contact Resistance: 30Milliohms Max.
 Operation Temperature : -55°C to +105°C.

Material

Contact :Copper Alloy.
 Insulator:PBT. (Select PA6T /LCP /PA9T)
 Shell: SPCC.
 Z-Piece: Copper Alloy.
 Screw: Copper Alloy.
 Rivet: Copper Alloy. or Zinc.



Note:

No.	A	B	C
09	16.32	24.99	30.81
15	25.25	33.32	39.14
25	38.96	47.04	53.04
37	55.42	63.50	69.32

- *C0550-XXMACXXBR
- *C0550-XXMBCXXBR
- *C0550-XXMBXXBR
- *C0550-XXMAEXXBR
- *C0550-XXMBEXXBR
- *C0550-XXMBDXXBR

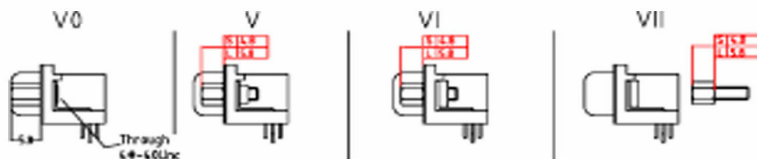
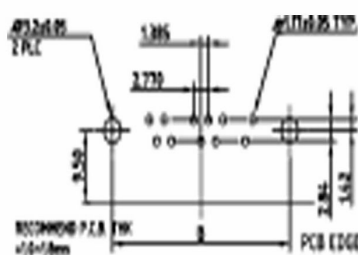

4

C0550-XXXBBXXBR

D-SUB PCB 90° 7.2mm STAMPED PIN XXP RIVET W/BOARDLOCK

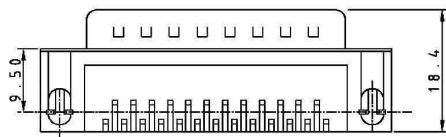
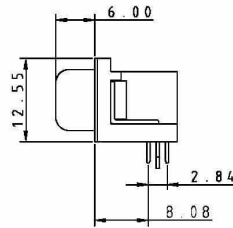
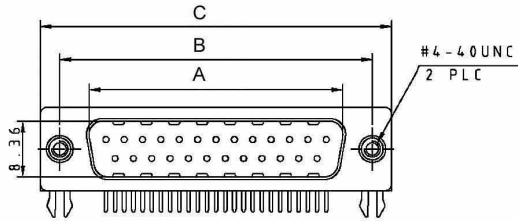

No.	A	B	C
09	16.33	24.99	30.81
15	24.66	33.32	39.14
25	38.38	47.04	53.04
37	54.83	63.50	69.32

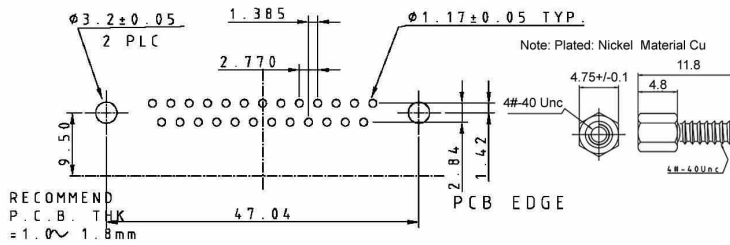

RECOMMEND
P.C.B. THICK
= 1.8mm

ELECTRICAL CHARACTERISTICS
 Contact Current Rating: 3Amperes.
 Dielectric Withstanding Voltage: AC 500V/60sec. r.m.s
 Insulation Resistance: 1000Megohms Minimum at DC 500V.
 Contact Resistance: 25 Milliohms Maximum.
 Operating Temperature: -55°C to +105°C

MATERIALS

Contact: Copper Alloy.
 Insulator: PBT.
 Shell: SPCC
 Z-Piece: Copper Alloy.
 Rivet: Copper Alloy or Fe.

ORDER INFORMATION

C0550-25MBAXXBR

- | | |
|--|--|
| 1. CONTACT NO:
09, 15, 25, 37 | 6. CONTACT PLATING
S: SELECTIVE GOLD |
| 2. CONTACT TYPE:
M: MALE F: FEMALE | G: GOLD FLASH
A: GOLD 5u"
B: GOLD 10u"
C: GOLD 15u"
D: GOLD 30u" |
| 3. MOUNTING OPTION:
B: RIVET W/BOARDLOCK
(Z-SHAPE) | 7. OTHERS:
B: BLACK
8. ROHS LOW LEAD |
| 4. ACCESSORIES:
A: NON ACCESSORIES
B: ADD SCREWS (4.8*11.8) | |
| 5. SHELL PLATING:
T: TIN
N: NICKEL
Z: ZINC (CHROMATIC)
A: TIN + DIMPLE
B: NICKEL + DIMPLE | |

ELECTRONIC COMPONENTS