

H4130 Series 3.0mm Crimp Terminal Housing

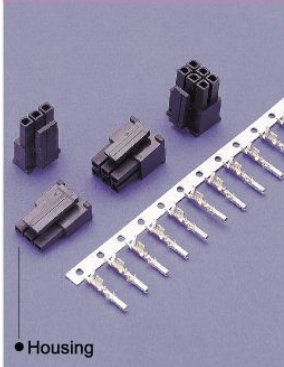

● Housing

H
4130
—
12
P
D
B
0
0
0

1. PRODUCTS:
 H:Housing

 2. SERIES NO.:
 4130(Male Housing)

 3. CONTACT NO.:
 02(1x2)-12(1x12)
 02(2x1)-24(2x12)

4. CONTACT TYPE:
 P:Non Distribution

 5. ROW TYPE:
 D: Dual Row
 S: Single Row

 6. INSULATOR COLOR:
 B: Black

7. FILL IT WITH "0"
 8. FILL IT WITH "0"
 9. FILL IT WITH "0"

1

H4130-XXPDB000R

3.0mm MALE HOUSING BLACK INSULATOR

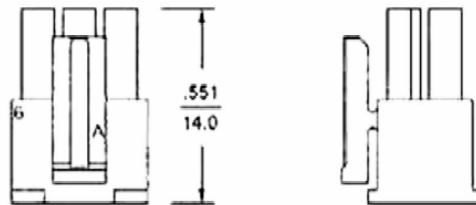
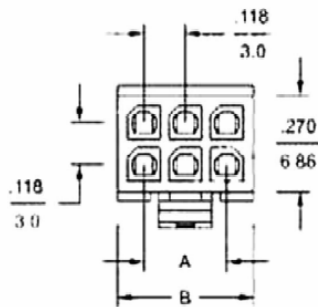

Dimensional Information - in (mm)

Circuits	Dim. A	Dim. B	Circuits	Dim. A	Dim. B	Circuits	Dim. A	Dim. B
2		0.157 (4.0)	10	0.472 (12.0)	0.630 (16.0)	18	0.945 (24.0)	1.102 (28.0)
4	0.115 (3.0)	0.276 (7.0)	12	0.581 (15.0)	0.748 (19.0)	20	1.063 (27.0)	1.220 (31.0)
6	0.236 (6.0)	0.394 (10.0)	14	0.709 (18.0)	0.866 (22.0)	22	1.181 (30.0)	1.339 (34.0)
8	0.354 (9.0)	0.512 (13.0)	16	0.827 (21.0)	0.984 (25.0)	24	1.299 (33.0)	1.457 (37.0)

Specifications:

- Voltage rating: 250V AC(RMS) or DC
- Dielectric Strength: 1500V AC/minute
- Current rating:

Wire size	# 20	# 22	# 24	# 26	# 28	# 30
Ampere	5 A	5 A	4 A	3 A	2 A	1 A

- Insulation resistance: 1000MΩ min.
- Contact resistance: 10mΩ max.
- Temperature rise: 30°C max.
(carry rated current load)

- Available in 2 thru 24 circuits
- Material: UL 94V-0
- Standard color: Black

ELECTRONIC
COMPONENTS

T4130 Series 3.0mm Crimp Contacts

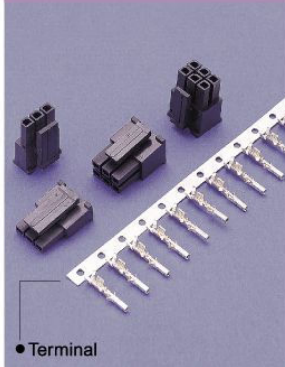

T	4130	—	T	B	I	0	0	0	0	0
1	2		3	4	5	6	7	8	9	10

- | | | |
|--|---|--|
| <p>1. PRODUCTS:
T:Terminal</p> <p>2. SERIES NO.:
4130(Female Terminal)</p> <p>3. CONTACT PLATING:
T: Tin
S: Selective Gold
G: Gold Flash</p> | <p>4. MATERIAL:
B: Brass
P: Phosphor Bronze</p> <p>5. WIRE OPTION:
G: Suitable For 20~24 Awg
I: Suitable For 22~26 Awg
N: Suitable For 26~30 Awg</p> <p>6. FILL IT WITH "0"</p> | <p>7. FILL IT WITH "0"</p> <p>8. FILL IT WITH "0"</p> <p>9. FILL IT WITH "0"</p> <p>10. FILL IT WITH "0"</p> |
|--|---|--|

1

T4130-TPI00000R**MICRO-FIT 3.0mm FEMALE TERMINAL SUITABLE FOR 22~26AWG**

Conductor: Phosphor Bronze/Tin Plated
Thickness: 0.2mm

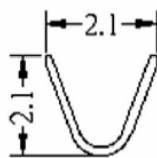

Section A-A

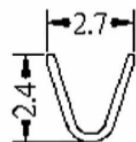

Section B-B

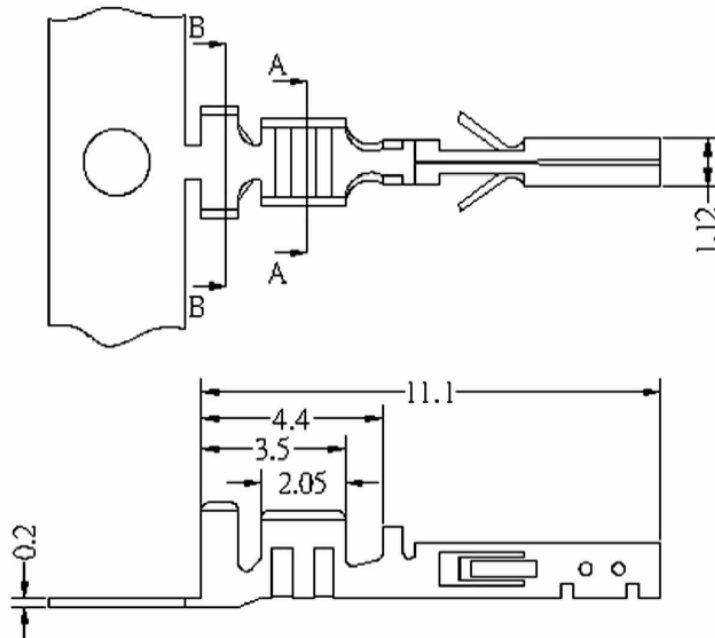

ELECTRONIC
COMPONENTS