

C6100 Series 2.0mm Pin Header H:2.0mm Single Row

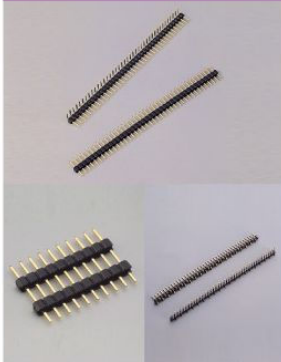

C	6100	—	40	A	S	G	AS	0
1	2		3	4	5	6	7	8

- | | | | |
|---|---|--|---|
| <p>1. PRODUCTS:
C: Connector</p> <p>2. SERIES NO.:
6100</p> <p>3. CONTACT NO.:
02(1x2)-40(1x40)</p> <p>4. ROW TYPE:
A: Single Row
E: Single Row/
Dual Insulator</p> | <p>5. CONTACT TYPE:
S: Straight
R: Right Angle
D: S.M.T. A Type
T: S.M.T. B Type</p> <p>6. CONTACT PLATING:
T: Tin
S: Selective Gold
G: Gold Flash
A: Gold 5U"
B: Gold 10U"
C: Gold 15U"
D: Gold 30U"</p> | <p>7. PIN LENGTH(mm):
AS(180°)—C: 3.9mm
 —D: 2.8mm
AR(90°)—C: 3.90mm
 —D: 3.00mm
 —E: 0.75mm
AT(S.M.T.)—C: 4.0mm
 —D: 4.2mm
 —E: 2.7mm</p> | <p>8. OTHERS:
O: No Option
T: Tube Packing
R: Reel Packing
P: PAD+Tube Packing
Q: PAD+Reel Packing</p> |
|---|---|--|---|

1 C6100-XXADXAT0 2.0X2.0 PIN HEADER SINGLE ROW H=2.0mm SMT A TYPE (C=4.0 D=4.2 E=2.7)

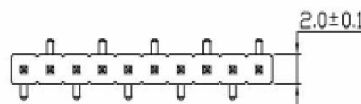

A=2.0*(No of Space)
B=A+2.0

SPECIFICATIONS

Current Rating: 2 Amps
Dielectric Withstanding: AC 500V
Operating Temperature: -40°C to +105°C
Max Processing Temp: 230° for 30-60 seconds
(260° for 10 seconds)

MATERIAL & FINISH

Contact: Brass
Insulator Material: Nylon 6T
Color: Black
Finish: Gold Flash Plated Over Nickel

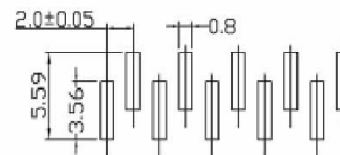
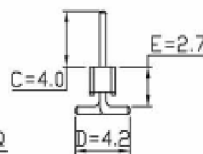
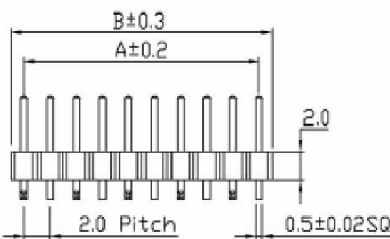

P.C. Board Layout

ORDER INFORMATION

C6100	Contact No.	Row Type	Contact Type	Contact Plating	Pin Length (mm)	Others
	40	A	D	G	A T	0
	02(1x2)-40(1x40)	A: Single Row	D: SMT A Type	T: Tin S: Selective Gold G: Gold Flash A: Gold 5U" B: Gold 10U" C: Gold 15U" D: Gold 30U"	AT(SMT): C=4.0mm D=4.2mm E=2.7mm	O: No Option T: Tube Packing R: Reel Packing P: PAD+Tube Packing Q: PAD+Reel Packing

ELECTRONIC COMPONENTS

2 C6100-XXARXAR0 2.0X2.0 PIN HEADER SINGLE ROW H=2.0mm RIGHT ANGLE (C=3.9 D=3.0 E=0.75)

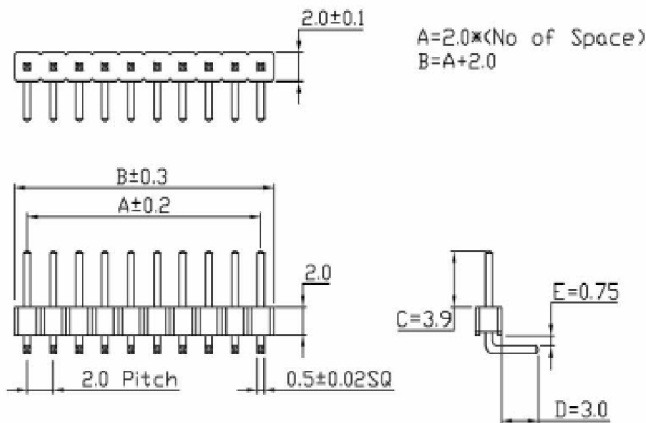

SPECIFICATIONS

Current Rating: 2 Amps
 Dielectric Withstanding: AC 500V
 Operating Temperature: -40°C to +105°C
 Max Processing Temp: 230° for 30-60 seconds
 (260° for 10 seconds)

MATERIAL&FINISH

Contact: Brass
 Insulator Material: PBT
 Color: Black
 Finish: Gold Flash Plated Over Nickel

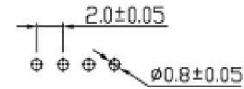

P.C.Board Layout

ORDER INFORMATION

C6100 -	Contact No.	Row Type	Contact Type	Contact Plating	Pin Length (mm)	Others
	40	A	R	G	A R	0
	021x2=40(1x40)	A: Single Row	R: Right Angle	T: Tin S: Selective Gold G: Gold Flash A: Gold 50" B: Gold 100" C: Gold 150" D: Gold 300"	C=3.9mm D=3.0mm E=0.75mm AR(90°)	0: No Option T: Tube Packing R: Reel Packing P: PAD+Tube Packing Q: PAD+Reel Packing

3 C6100-XXARXAS0R 2.0mm PIN HEADER SINGLE ROW 1XXXP RIGHT ANGLE H=2.0mm(C=3.9 D=2.8 E=0.75)

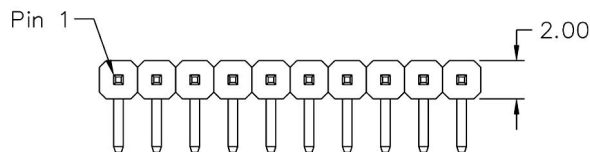

MATERIAL

Insulator : 30% Glass fiber PBT
 Contact Pin : Brass

SPECIFICATION

Current Rate : 1 AMP
 Insulation Resistance : 5000MΩMin. at DC 500V
 Contact Resistance : 20mΩMax. at DC 100mA
 Dielectric Voltage : AC 500V for one minute
 Operation Temperature : -40°C to + 105°C

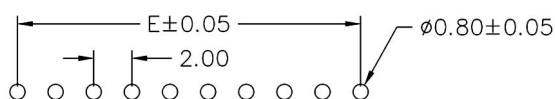
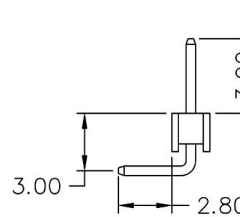
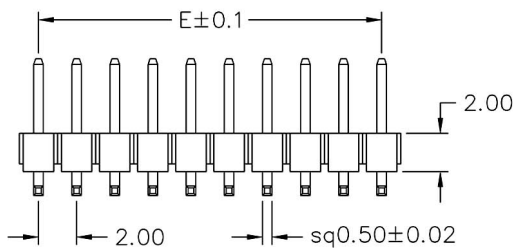

Recommended P.C.B Layout

4 C6100-XXATXAT0 2.0X2.0 PIN HEADER SINGLE ROW H=2.0mm SMT B TYPE (C=4.0 D=4.2 E=2.7)

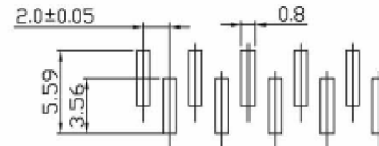
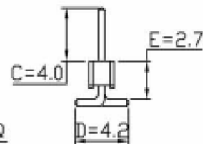
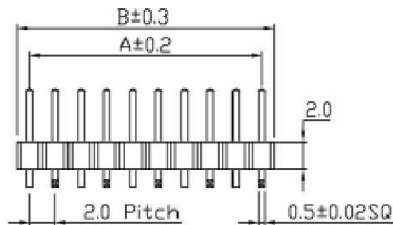
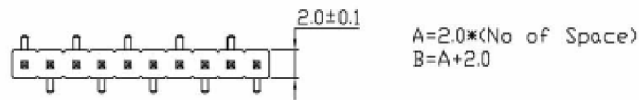

P.C.Board Layout

ORDER INFORMATION

Contact No.	Row Type	Contact Type	Contact Plating	Pin Length (mm)	Others
C6100 - 40	A	T	G	A T	0
02(1X2)-40(1X40)	A: Single Row	T: SMT B Type	T: Tin S: Selective Gold G: Gold Flash A: Gold 50" B: Gold 100" C: Gold 150" D: Gold 200"	AT(SMT): C=4.0mm D=4.2mm E=2.7mm	0: No Option T: Tube Packing R: Reel Packing P: PAD+Tube Packing Q: PAD+Reel Packing

5 C6100-XXADXAT0 2.0X2.0 PIN HEADER SINGLE ROW H=2.0mm SMT A TYPE (C=4.0 D=4.2 E=2.7)

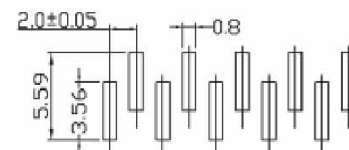
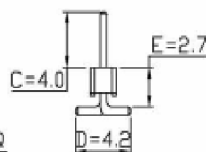
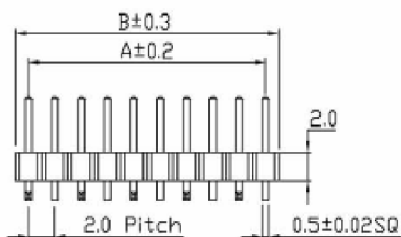
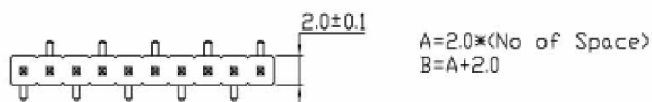

P.C.Board Layout

ORDER INFORMATION

Contact No.	Row Type	Contact Type	Contact Plating	Pin Length (mm)	Others
C6100 - 40	A	D	G	A T	0
02(1X2)-40(1X40)	A: Single Row	D: SMT A Type	T: Tin S: Selective Gold G: Gold Flash A: Gold 50" B: Gold 100" C: Gold 150" D: Gold 200"	AT(SMT): C=4.0mm D=4.2mm E=2.7mm	0: No Option T: Tube Packing R: Reel Packing P: PAD+Tube Packing Q: PAD+Reel Packing

ELECTRONIC
COMPONENTS

6 C6100-XXARXAR0 2.0X2.0 PIN HEADER SINGLE ROW H=2.0mm RIGHT ANGLE (C=3.9 D=3.0 E=0.75)

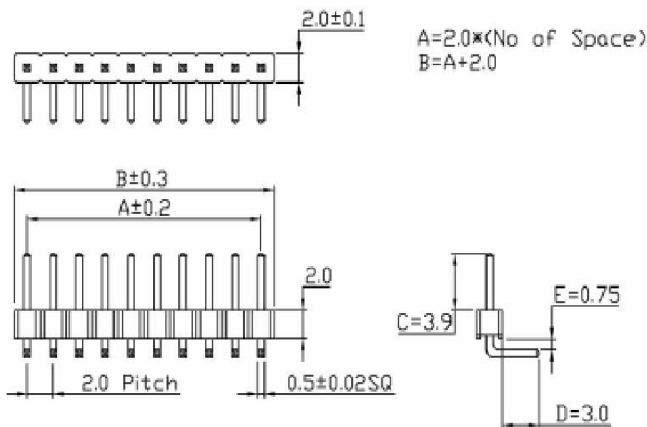

SPECIFICATIONS

Current Rating: 2 Amps
 Dielectric Withstanding: AC 500V
 Operating Temperature: -40°C to +105°C
 Max Processing Temp: 230° for 30-60 seconds
 (260° for 10 seconds)

MATERIAL & FINISH

Contact: Brass
 Insulator Material: PBT
 Color: Black
 Finish: Gold Flash Plated Over Nickel

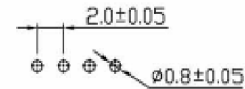

P.C. Board Layout

ORDER INFORMATION

C6100 -	Contact No.	Row Type	Contact Type	Contact Plating	Pin Length (mm)	Others
	40	A	R	G	A R	0
	02(1x2)-40(1x40)	A: Single Row	R: Right Angle	T: Tin S: Selective Gold G: Gold Flash A: Gold SnP B: Gold 10U" C: Gold 15U" D: Gold 30U"	A: C=3.9mm R: D=3.0mm E=0.75mm	0: No Option 1: Tube Packing 2: Reel Packing P: PAD+Tube Packing Q: PAD+Reel Packing

7 C6100-XXARXAS0R 2.0mm PIN HEADER SINGLE ROW 1X??P RIGHT ANGLE H=2.0mm (C=3.9 D=2.8 E=0.75)

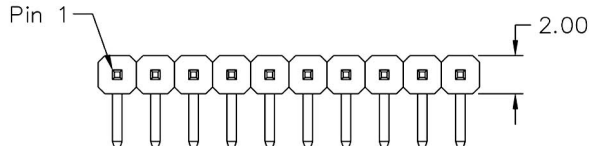

MATERIAL

Insulator : 30% Glass fiber PBT
 Contact Pin : Brass

SPECIFICATION

Current Rate : 1 AMP
 Insulation Resistance : 5000MΩMin. at DC 500V
 Contact Resistance : 20mΩMax. at DC 100mA
 Dielectric Voltage : AC 500V for one minute
 Operation Temperature : -40°C to + 105°C

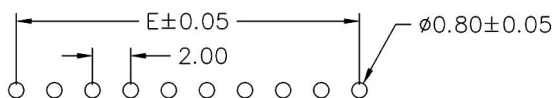
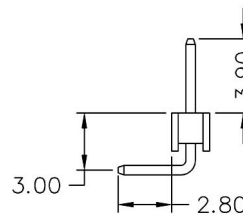
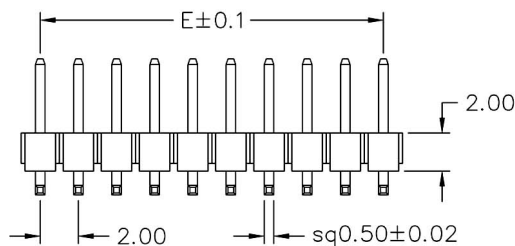

Recommended P.C.B Layout

8 C6100-XXATXAT0 2.0X2.0 PIN HEADER SINGLE ROW H=2.0mm SMT B TYPE (C=4.0 D=4.2 E=2.7)

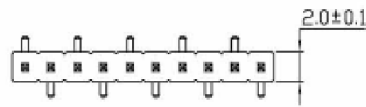

A=2.0*(No of Space)
B=A+2.0

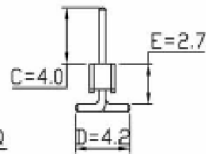
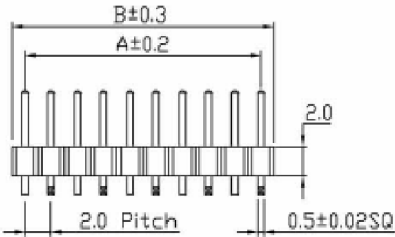

SPECIFICATIONS

Current Rating: 2 Amps
Dielectric Withstanding: AC 500V
Operating Temperature: -40°C to +105°C
Max Processing Temp: 230° for 30-60 seconds
(260° for 10 seconds)

MATERIAL & FINISH

Contact: Brass
Insulator Material: Nylon 6T
Color: Black
Finish: Gold Flash Plated Over Nickel

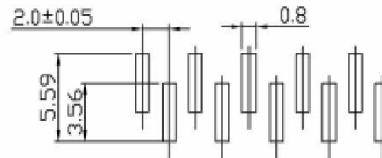

P.C. Board Layout

ORDER INFORMATION

C6100 -

Contact No.

Row Type

Contact Type

Contact Plating

Pin Length (mm)

Others

02K1x2+40K1x40

A: Single Row

T: SMT B Type

T: Tin
S: Selective Gold
G: Gold Flash
A: Gold 50U
B: Gold 150U
C: Gold 150U
D: Gold 30U

A: C=4.00mm
T: C=4.25mm
E=2.7mm

0: No Option
1: Tube Packing
2: Reel Packing
P: PAD+Tube Packing
Q: PAD+Reel Packing

9 C6100-XXASGAS0R 2.0mm PIN HEADER SINGLE ROW 1X??P STRAIGHT TYPE H=2.0mm (C=3.9 D=2.8 E=2.0)

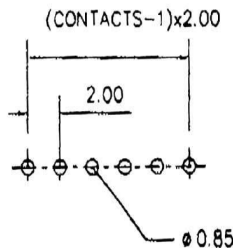
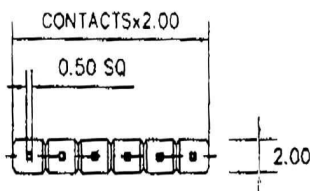

MATERIAL
HOUSING : THERMOPLASTIC UL94V-0
CONTACT : COPPER ALLOYS

SPECIFICATION

CURRENT: 1A
OPERATING TEMPERATURE: -55°C TO +105°C
CONTACT RESISTANCE : 20 MILLIOHMS MAX
INSULATION RESISTANCE : 5000 MEGAOHMS MIN
DIELECTRIC STRENGTH : 1000 VAC MIN
DURABILITY : 100 CYCLES
RETENTION FORCE : 700g MIN

FINISH

CONTACT PLATING SEE ORDER INFORMATION

RECOMMENDED P.C.B LAYOUT

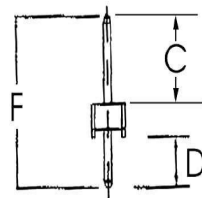
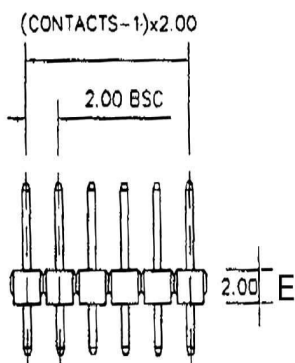

CONTACTS	1X21
1X2	1X22
1X3	1X23
1X4	1X24
1X5	1X25
1X6	1X26
1X7	1X27
1X8	1X28
1X9	1X29
1X10	1X30
1X11	1X31
1X12	1X32
1X13	1X33
1X14	1X34
1X15	1X35
1X16	1X36
1X17	1X37
1X18	1X38
1X19	1X39
1X20	1X40

F : 8.7 mm C : 3.9 mm D : 2.8 mm